



K427 REVOLVE - LED

The K427 Revolve has a smoothly angled housing with three aluminum struts that add to its contemporary appearance. Available in P4 Advanced Technology, this luminaire also offers LED efficiency and energy savings. This unique fixture is ideal for parking lots, waterfronts and streetscapes.



PROJECT: _____

PREPARED BY: _____

DATE: _____

PRODUCT SPECIFICATIONS

LED ENGINE

Light engine shall include an array of 30 solid state Cree X-Series high power LEDs (light emitting diodes). The emitters shall be mounted to a metal core circuit board using SMT technology. The circuit board shall then be mounted to a cast aluminum engine plate which is exposed to outside ambient air to provide dynamic airflow for cooling the system.

OPTICS

External light control shall consist of high precision refractive lenses mounted above the LED emitter arrays in such a way to achieve optimum uplight control. The lenses shall also control horizontal light distribution so that Type II, III, IV or V IESNA distribution patterns are achieved.

LUMINAIRE CONSTRUCTION

The luminaire shall consist of a heavy gauge aluminum housing that acts as the enclosure for the engine and is of adequate thickness to give structural rigidity. The engine must be affixed to the housing with stainless steel screws. The housing is attached to the cast aluminum capital with three aluminum struts.

The capital shall have an opening at the base tenon body to allow the luminaire to be mounted to a tenon of 3" maximum diameter. The luminaire shall be locked in place by means of heavy duty, stainless steel set-screws.

DRIVER

The LED universal dimmable driver will be class 2 and capable of 120 - 277V or 347 - 480V input voltage, greater than 0.9 power factor, less than 20% total harmonic distortion. The case temperature of the driver can range from -40°C up to 70°C. Each LED system comes with a standard surge protection designed to withstand up to 20kV/10kA of transient line surge as per IEEE C62.41.2 C High. An in-line ferrite choke is utilized to provide protection against EFT's. The driver assembly will be mounted on a fabricated aluminum bracket.

PHOTOMETRICS

Fixtures are tested to IESNA LM79 specifications. These reports are available upon request.

CHROMATICITY

High output LEDs come standard at 3000K & 4000K (+/- 300K) with a minimum nominal 70 CRI. Additional CCT emitters are available upon request.

LUMEN MAINTENANCE

Reported (TM21) and Calculated (L70) reports are available upon request with a minimum calculated value of 100,000 hrs.

WIRING

All internal wiring and connections shall be completed so that it will be necessary only to attach the incoming supply connectors to Mate-N-Lok connectors or to a terminal block. Mate-N-Lok shall be certified for 600V operation. Internal wire connectors shall be crimp connector only and rated at 1000V and 150°C. All wiring to be CSA certified and/or UL listed, type SFF-2, SEWF-2, or SEW-2 No. 14 gauge, 150°C, 600V, and color coded for the required voltage.

THERMALS

Fixtures tested to DOE sanctioned standards to determine the maximum in-situ solder-point or junction-point temperatures of the LED emitters. This report is available upon request.

FINISH

Housing is finished with a 13 step KingCoat™ SuperDurable polyester TGIC powder coat. Standard colors include strobe white, brown metal, marina blue, gate gray, Chicago bronze, standard gold, standard black, federal green and rain forest. Please see our website for a complete list of colors. RAL and custom color matches are available.

MISCELLANEOUS

All exterior hardware and fasteners, wholly or partly exposed, shall be stainless steel alloy. All internal fasteners are stainless steel or zinc coated steel. All remaining internal hardware is stainless steel, aluminum alloy, or zinc coated steel.

WARRANTY

The K427 Revolve LED luminaire comes with a 7 year limited warranty.

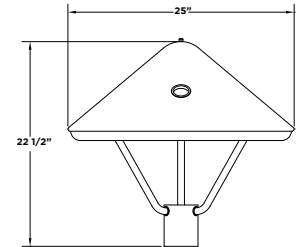

CERTIFICATION:

CSA US Listing in process
Suitable for wet locations
ISO 9001
IP66
ARRA Compliant
LM79 / LM80 Compliant

DRIVER INFO:

>0.9 Power Factor
<20% Total Harmonic Distortion
120 - 277V & 347 - 480V
-40°C Min. Case Temperature
70°C Max. Case Temperature
Surge Protection: ANSI 136.2
extreme level 20 kV/10 kA

EPA:

0.68 sq. ft.

FIXTURE WEIGHT:

20 lbs



Contact King Luminaire for product specifications that are exempt from CSA Certification 12-20-2018



Test Voltage: 120V
Nominal Color Temperature: 3000K & 4000K¹
7030 Engine Series: 30 Emitters (40 - 100W Max)
LED Engine + Driver Rated Life = 100,000 hrs²

To learn more about the P4 Optic, please see the P4 7030 Optic Information Sheet

	Photometric Test Report Number	Decorative Option	Color Temperature	IES Distribution	Nominal Watts	Engine Series	Delivered Lumens ³	Efficacy (LM/W) ³	mA @ Emitter	Driver Output Current	BUG Rating	HID Equivalent ⁴
Flat Lens	0427TP4FL3X04030XXB	Flat Lens	3000	Type III	40	7030	4311	102.9	400	2000	1-0-1	50 - 70
	0427TP4FL3X04040XXA	Flat Lens	4000	Type III	40	7030	4165	99.4	400	2000	1-0-1	50 - 70
	0427TP4FL5X04030XXB	Flat Lens	3000	Type V	40	7030	4238	101.6	400	2000	2-0-1	50 - 70
	0427TP4FL5X04040XXA	Flat Lens	4000	Type V	40	7030	4100	97.9	400	2000	2-0-1	50 - 70
	0427TP4FL3X06030XXB	Flat Lens	3000	Type III	60	7030	5896	96	600	3000	1-0-1	70 - 100
	0427TP4FL3X06040XXA	Flat Lens	4000	Type III	60	7030	5665	92.7	600	3000	1-0-1	70 - 100
	0427TP4FL5X06030XXB	Flat Lens	3000	Type V	60	7030	5763	94.6	600	3000	2-0-1	70 - 100
	0427TP4FL5X06040XXA	Flat Lens	4000	Type V	60	7030	5564	91.1	600	3000	2-0-1	70 - 100
	0427TP4FL3X07530XXB	Flat Lens	3000	Type III	75	7030	6848	91.2	800	4000	1-0-2	100 - 150
	0427TP4FL3X07540XXA	Flat Lens	4000	Type III	75	7030	6624	88.8	800	4000	1-0-1	100 - 150
	0427TP4FL5X07530XXB	Flat Lens	3000	Type V	75	7030	6738	90.2	800	4000	2-0-2	100 - 150
	0427TP4FL5X07540XXA	Flat Lens	4000	Type V	75	7030	6499	87.1	800	4000	2-0-2	100 - 150
	0427TP4FL3X10030XXB	Flat Lens	3000	Type III	100	7030	8160	83.9	960	4800	2-0-2	150 - 200
	0427TP4FL3X10040XXA	Flat Lens	4000	Type III	100	7030	7874	82.1	960	4800	2-0-2	150 - 200
	0427TP4FL5X10030XXB	Flat Lens	3000	Type V	100	7030	8039	83.3	960	4800	2-0-2	150 - 200
	0427TP4FL5X10040XXA	Flat Lens	4000	Type V	100	7030	7755	80.9	960	4800	2-0-2	150 - 200

¹Color temperature is nominal, please see test report for specific chromaticity information

²Contact factory for TM21 information

³Due to the continuous advancements in LED technology, luminaire delivered lumen and efficacy is subject to change without notice at the discretion of King Luminaire

⁴Equivalence should always be confirmed by performing a photometric layout, due to the variability of performance requirements and application criteria

HOW TO ORDER

